

TRAFFIC SWINGING SINGLE LEAF DOORS

ALL PRICES IN EURO, DO NOT INCLUDE VAT. 2 MM THICK METAL DOOR FRAME INCLUDED

(TSD)

08.07.2024

- traffic of personnel.
- The factory-made doors are ready for installation on technological, industrial premises, supermarkets, hospitals, food production facilities, cafes, restaurants, etc.
- Traffic doors are not meant to completely seal the opening due to technical clearance gaps along the perimeter between the frame and the door leaf.
- If you need the doors to remain open in 90-degree position, you can order traffic doors with fixing hinges. Doors can be equipped with oval windows of 200x500 or 300x580 mm.
- Traffic doors are available in custom sizes and are equipped with the European-made hardware: Italian, Spanish, — according to customer's request.

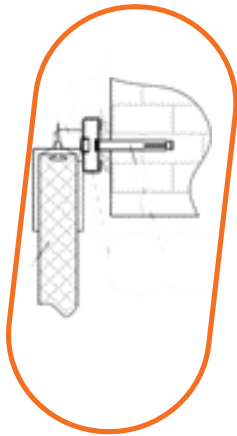

OVERHEAD FRAME

RAL 9003	INSTALLATION OPENING, HEIGHT, MM	INSTALLATION OPENING, WIDTH, MM						
		700	800	900	1 000	1 100	1 200	1 300
1 800	326	359	366	377	383	398	472	
1 900	330	365	372	382	390	467	479	
2 000	334	370	377	388	396	473	486	
2 100	338	376	383	395	463	480	493	
2 200	343	383	391	403	471	489	502	
2 300	350	392	400	473	481	500	578	
2 400	354	398	406	479	487	506	585	
2 500	429	477	486	501	510	530	611	
2 600	434	484	493	508	517	602	619	
2 700	440	491	500	515	525	611	627	
2 800	445	499	508	523	597	620	637	
2 900	511	566	577	593	604	628	645	
3 000	516	573	584	601	612	636	653	
3 100	522	581	592	609	620	644	662	
3 200	527	588	599	616	628	652	671	
3 300	532	595	606	624	636	661	679	

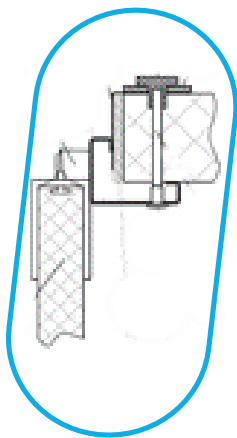

ANGULAR FRAME

RAL 9003	INSTALLATION OPENING, HEIGHT, MM	INSTALLATION OPENING, WIDTH, MM						
		700	800	900	1 000	1 100	1 200	1 300
1 800	345	380	387	398	405	421	498	
1 900	350	386	393	405	412	492	505	
2 000	354	392	399	411	419	499	513	
2 100	359	398	406	418	488	506	520	
2 200	363	404	412	425	494	513	528	
2 300	371	415	423	498	507	526	606	
2 400	376	421	430	505	514	534	614	
2 500	453	502	511	526	536	557	641	
2 600	459	510	520	535	546	633	651	
2 700	467	520	530	546	556	645	663	
2 800	473	527	538	554	629	653	672	
2 900	540	597	608	626	638	662	681	
3 000	547	606	617	635	647	672	691	
3 100	553	613	625	643	656	681	700	
3 200	557	620	632	650	663	689	708	
3 300	565	630	642	661	674	700	720	





OVERLAPPING FRAME

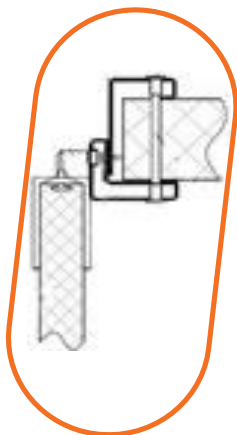

RAL 9003

INSTALLATION OPENING, HEIGHT, MM	INSTALLATION OPENING, WIDTH, MM						
	700	800	900	1 000	1 100	1 200	1 300
1 800	409	447	456	470	479	498	580
1 900	416	455	465	479	489	574	590
2 000	427	468	478	493	503	589	606
2 100	434	477	487	502	576	599	616
2 200	441	485	496	511	586	609	627
2 300	452	499	509	589	601	625	711
2 400	459	508	519	600	612	636	723
2 500	544	598	610	629	641	667	757
2 600	554	609	622	641	653	749	770
2 700	562	619	632	651	664	761	782
2 800	571	630	643	663	744	773	795
2 900	644	706	719	741	755	785	807
3 000	655	719	733	755	770	800	823
3 100	663	729	744	766	781	812	835
3 200	668	736	751	774	789	820	843
3 300	677	747	762	785	800	832	856

OUR DOORS ARE AVAILABLE IN CUSTOM SIZES TO INSURE BEST COMMERCIAL APPLICATION

TRAFFIC SWINGING DOUBLE LEAF DOORS

ALL PRICES IN EURO, DO NOT INCLUDE VAT. 2 MM THICK METAL DOOR FRAME INCLUDED

(TDD)

08.07.2024

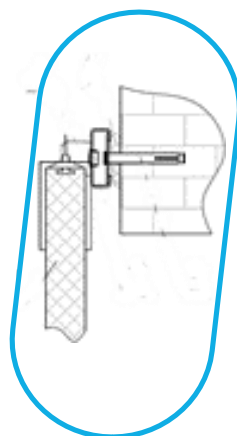

RAL 9003

OVERHEAD FRAME

INSTALLATION OPENING, HEIGHT, MM	INSTALLATION OPENING, WIDTH, MM				
	1 000	1 100	1 200	1 300	1 400
1 800	603	606	614	617	678
1 900	610	614	621	624	689
2 000	618	621	629	632	700
2 100	625	628	636	640	711
2 200	632	636	644	647	722
2 300	645	649	658	661	740
2 400	660	664	672	676	759
2 500	806	810	818	823	911
2 600	819	824	833	837	928
2 700				847	942
2 800				859	957
2 900				999	1 100
3 000				1 009	1 114
3 100				1 020	1 129
3 200				1 030	1 142
3 300				1 041	1 157

OVERHEAD FRAME

INSTALLATION OPENING, HEIGHT, MM	INSTALLATION OPENING, WIDTH, MM				
	1 500	1 600	1 700	1 800	1 900
1 800	681	684	687	691	694
1 900	692	695	699	702	705

RAL 9003	2 000	703	707	710	714	717
	2 100	714	718	722	725	729
	2 200	726	730	733	737	741
	2 300	744	748	752	756	886
	2 400	763	768	772	776	908
	2 500	915	919	924	928	932
	2 600	933	937	942	946	951
	2 700	947	951	956	961	965
	2 800	962	967	972	977	982
	2 900	1 106	1 111	1 116	1 121	1 126
	3 000	1 119	1 125	1 130	1 135	1 140
	3 100	1 134	1 139	1 145	1 150	1 155
	3 200	1 148	1 153	1 159	1 164	1 170
	3 300	1 163	1 169	1 174	1 180	1 186

OVERHEAD FRAME

	INSTALLATION OPENING, HEIGHT, MM	INSTALLATION OPENING, WIDTH, MM						
		2 000	2 100	2 200	2 300	2 400	2 500	2 600
RAL 9003	1 800	697	721	724	728	731	862	867
	1 900	708	733	737	868	872	875	880
	2 000	721	746	749	882	885	889	893
	2 100	732	887	890	894	898	901	906
	2 200	745	900	903	907	911	915	920
	2 300	890	921	925	929	933	1 067	1 072
	2 400	912	943	948	952	956	1 092	1 097
	2 500	937	969	974	978	983	1 121	1 126
	2 600	955	989	994	1 131	1 136	1 141	1 147
	2 700	970	1 004	1 009	1 147	1 152	1 157	1 163
	2 800	986	1 154	1 160	1 165	1 169	1 174	1 181
	2 900	1 131	1 170	1 175	1 180	1 185	1 190	1 197
	3 000	1 145	1 185	1 190	1 196	1 201	1 206	1 213
	3 100	1 161	1 201	1 206	1 212	1 217	1 223	1 229
	3 200	1 175	1 216	1 222	1 227	1 233	1 239	1 245
	3 300	1 191	1 233	1 239	1 244	1 250	1 256	1 263

ANGULAR FRAME

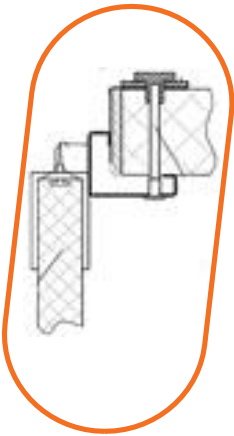

	INSTALLATION OPENING, HEIGHT, MM	INSTALLATION OPENING, WIDTH, MM				
		1 000	1 100	1 200	1 300	1 400
RAL 9003	1 800	624	627	635	638	700
	1 900	632	636	644	647	713
	2 000	640	644	652	656	725
	2 100	648	652	660	664	737
	2 200	657	661	669	673	749
	2 300	671	675	684	688	768
	2 400	686	690	699	704	788
	2 500	833	838	847	851	940
	2 600	847	852	861	866	958
	2 700				877	972
	2 800				888	987
	2 900				1 029	1 131
	3 000				1 041	1 147
	3 100				1 052	1 161
	3 200				1 061	1 174
	3 300				1 072	1 189

ANGULAR FRAME

	INSTALLATION OPENING, HEIGHT, MM	INSTALLATION OPENING, WIDTH, MM			
		1 500	1 600	1 700	1 800
1 800	704	707	711	714	718
1 900	716	720	723	727	731
2 000	728	732	736	740	744
2 100	741	745	749	753	756
2 200	753	757	761	765	769

RAL 9003	2 300	772	776	781	785	917
	2 400	792	797	801	806	939
	2 500	945	949	954	959	963
	2 600	963	967	972	977	982
	2 700	977	982	987	992	997
	2 800	992	997	1 002	1 007	1 012
	2 900	1 137	1 142	1 147	1 152	1 158
	3 000	1 152	1 158	1 163	1 169	1 174
	3 100	1 167	1 172	1 178	1 184	1 189
	3 200	1 180	1 186	1 192	1 198	1 204
	3 300	1 195	1 201	1 207	1 213	1 219

ANGULAR FRAME

	INSTALLATION OPENING, HEIGHT, MM	INSTALLATION OPENING, WIDTH, MM						
		2 000	2 100	2 200	2 300	2 400	2 500	2 600
RAL 9003	1 800	721	747	750	754	757	890	896
	1 900	734	760	764	897	901	905	911
	2 000	747	774	778	911	915	919	925
	2 100	760	917	921	925	929	933	940
	2 200	773	931	935	939	944	948	954
	2 300	921	953	958	962	967	1 102	1 109
	2 400	944	977	981	986	991	1 128	1 135
	2 500	968	1 002	1 007	1 012	1 016	1 155	1 162
	2 600	987	1 022	1 026	1 166	1 171	1 176	1 183
	2 700	1 002	1 038	1 043	1 182	1 187	1 192	1 199
	2 800	1 018	1 188	1 193	1 198	1 204	1 209	1 216
	2 900	1 163	1 204	1 209	1 215	1 220	1 226	1 233
	3 000	1 180	1 221	1 226	1 232	1 238	1 243	1 251
	3 100	1 195	1 237	1 243	1 248	1 254	1 260	1 268
	3 200	1 209	1 252	1 258	1 264	1 270	1 276	1 284
3 300	1 225	1 267	1 274	1 280	1 286	1 292	1 300	

OVERLAPPING FRAME

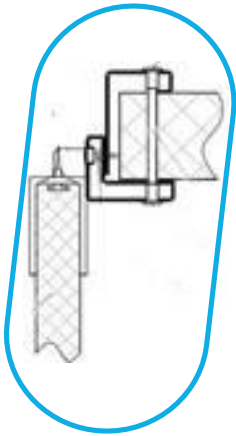

	INSTALLATION OPENING, HEIGHT, MM	INSTALLATION OPENING, WIDTH, MM				
		1 000	1 100	1 200	1 300	1 400
RAL 9003	1 800	701	705	714	719	784
	1 900	713	717	727	732	800
	2 000	723	728	737	742	814
	2 100	735	741	750	756	832
	2 200	746	751	761	766	846
	2 300	764	770	780	786	869
	2 400	785	791	801	807	895
	2 500	939	945	955	961	1 053
	2 600	954	961	971	977	1 073
	2 700				991	1 090
	2 800				1 005	1 108
	2 900				1 153	1 259
	3 000				1 170	1 280
	3 100				1 184	1 297
	3 200				1 194	1 311
3 300				1 208	1 329	

OVERLAPPING FRAME

	INSTALLATION OPENING, HEIGHT, MM	INSTALLATION OPENING, WIDTH, MM				
		1 500	1 600	1 700	1 800	1 900
9003	1 800	789	794	798	803	808
	1 900	805	810	815	820	825
	2 000	820	825	830	835	840
	2 100	837	842	847	853	858
	2 200	851	857	862	867	873
	2 300	875	881	886	892	1 029
	2 400	901	907	913	919	1 058
	2 500	1 060	1 066	1 072	1 078	1 084

RAL	2 600	1 079	1 085	1 092	1 098	1 104
	2 700	1 097	1 103	1 110	1 116	1 122
	2 800	1 114	1 121	1 127	1 134	1 141
	2 900	1 266	1 272	1 279	1 286	1 292
	3 000	1 287	1 293	1 300	1 307	1 314
	3 100	1 304	1 311	1 318	1 325	1 332
	3 200	1 319	1 326	1 333	1 340	1 347
	3 300	1 336	1 343	1 351	1 358	1 365

OVERLAPPING FRAME

INSTALLATION OPENING, HEIGHT, MM	INSTALLATION OPENING, WIDTH, MM							
	2 000	2 100	2 200	2 300	2 400	2 500	2 600	
RAL 9003	1 800	813	842	847	852	857	995	1 006
	1 900	830	860	865	1 004	1 009	1 014	1 025
	2 000	845	876	881	1 020	1 025	1 031	1 041
	2 100	863	1 029	1 034	1 040	1 045	1 051	1 061
	2 200	878	1 044	1 050	1 056	1 061	1 067	1 078
	2 300	1 035	1 072	1 078	1 083	1 089	1 231	1 242
	2 400	1 064	1 102	1 108	1 114	1 120	1 263	1 275
	2 500	1 090	1 129	1 135	1 141	1 148	1 291	1 303
	2 600	1 110	1 150	1 157	1 300	1 307	1 313	1 325
	2 700	1 129	1 169	1 176	1 320	1 326	1 333	1 345
	2 800	1 147	1 326	1 332	1 339	1 346	1 353	1 365
	2 900	1 299	1 345	1 352	1 359	1 366	1 373	1 385
	3 000	1 321	1 368	1 375	1 382	1 389	1 396	1 409
	3 100	1 339	1 387	1 394	1 401	1 408	1 416	1 429
	3 200	1 355	1 403	1 410	1 417	1 425	1 432	1 445
	3 300	1 373	1 422	1 429	1 437	1 444	1 452	1 465

OUR DOORS ARE AVAILABLE IN CUSTOM SIZES TO INSURE BEST COMMERCIAL APPLICATION

DOOR CATALOGUE CODES

TSD	SWINGING SINGLE LEAF DOORS
TDD	SWINGING DOUBLE LEAF DOORS
RIGHT / LEFT	HINGES ON THE RIGHT / HINGES ON THE LEFT

EXAMPLE OF DOOR CATALOGUE CODE: TSD 800 2000 40 RAL9003/RAL9003 ANG RIGHT

DOOR TYPE	DOORWAY WIDTH	DOORWAY HEIGHT	DOOR THICKNESS	COVERING MATERIAL		FRAME TYPE	HINGES LOCATION
				EXTERIOR METAL	INTERIOR METAL		
TSD	800	2 000	40	RAL9003	RAL9003	ANGULAR	RIGHT

ADDITIONAL OPTIONS FOR TRAFFIC SWINGING DOORS

ITEM	PRICE
TDD FRAME INSTALLATION HARDWARE TO INSULATED SANDWICH PANELS	12
PANELS	9
TDD FRAME INSTALLATION HARDWARE TO A BRICK WALL	7
TSD FRAME INSTALLATION HARDWARE TO A BRICK WALL	4
FRAME INSTALLATION HARDWARE FOR STEEL STUD CONSTRUCTION	2
DOOR BLADE MATERIAL: AISI 304, PRICE FOR 1 SQ. M	30
DOOR BLADE MATERIAL: AISI 430, PRICE FOR 1 SQ. M	21
OVERHEAD FRAME AISI 304, PRICE FOR RUNNING METER	17
ANGULAR FRAME AISI 304, PRICE FOR RUNNING METER	30
OVERLAPPING FRAME AISI 304, PRICE FOR RUNNING METER	78
OVERHEAD FRAME AISI 430, PRICE FOR RUNNING METER	10
ANGULAR FRAME AISI 430, PRICE FOR RUNNING METER	17

OVERLAPPING FRAME AISI 430, PRICE FOR RUNNING METER	46
HIDDEN INSTALLATION HARDWARE FOR TSD	42
HIDDEN INSTALLATION HARDWARE FOR TDD	50
HIDDEN INSTALLATION HARDWARE FOR TSD WITH AISI 304 FRAME	58
HIDDEN INSTALLATION HARDWARE FOR TDD WITH AISI 304 FRAME	51
HIDDEN INSTALLATION HARDWARE FOR TSD WITH AISI 430 FRAME	68
HIDDEN INSTALLATION HARDWARE FOR TDD WITH AISI 304 FRAME	60

FACTORY INSTALLED BUMPERS FOR TSD

BUMPER MATERIAL	THICKNESS, MM	PRICE FOR SQ. M	PRICE FOR RUNNING METER	
			BOTTOM 0,25 M	BOTTOM 0,5 M
AISI 304	1,5	103	26	52
AISI 430	1,5	68	17	34
ALUMINIUM CHECKER PLATE	1,5	47	12	24
FLAT HDP PLASTIC	4,0	31	8	15
CURVED HDP PLASTIC	6,0	43	11	22

FACTORY INSTALLED BUMPERS FOR TDD

BUMPER MATERIAL	THICKNESS, MM	PRICE FOR SQ. M	PRICE FOR RUNNING METER	
			BOTTOM 0,25 M	BOTTOM 0,5 M
AISI 304	1,5	108	27	54
AISI 430	1,5	71	18	36
ALUMINIUM CHECKER PLATE	1,5	49	12	25
FLAT HDP PLASTIC	4,0	32	8	16
CURVED HDP PLASTIC	4,0	36	9	18
CURVED HDP PLASTIC	6,0	44	11	22

PACKAGING

ITEM	PRICE
STRETCH-WRAP	INCLUDED IN DOOR PRICE
CARDBOARD PACKAGING	CALCULATED INDIVIDUALLY FOR YOUR ORDER
WOODEN PACKAGING	CALCULATED INDIVIDUALLY FOR YOUR ORDER



+7 (495) 745-01-37

WWW.PROFHOLOD.COM